

Electro Magnetic Chuck

SAV 243.41

With fine longitudinal pole pitch $P = 4 \text{ mm}$

Electromagnetic system with very narrow pole pitch. Especially suitable for thin workpieces. Workpiece positioning in cross direction of the chuck.

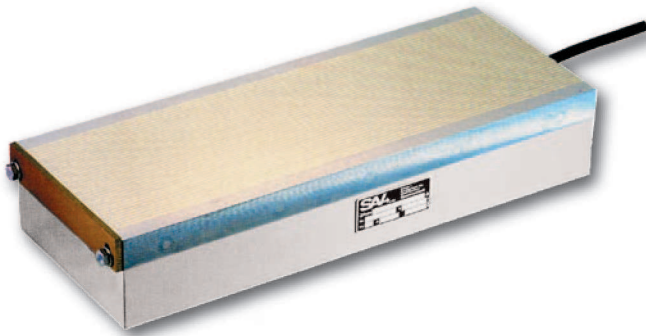

Use:

Clamping of thin, plate shaped workpieces with form and positional tolerances of 0.01 to 0.02 mm.

- for workpiece positioning cross to pole pitch

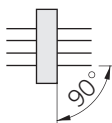

- for thin workpieces of min. 2 mm thick

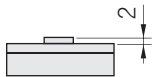

- for flat workpieces with min. dimensions 40 x 40 mm

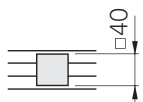

Nominal holding force:

100 N/cm²,
adjustable with control unit
with encoded switch

Nominal operating voltage:

24 V DC up to 118 W
110 V DC for all sizes

Features:

- especially fine, uninterrupted longitudinal pole pitch, 3 mm steel and 1 mm brass
- glued lamination with additional pull anchors cross to lamination
- fine grid pole plate to body connection
- 8 mm pole plate wearing limit
- low magnetic field height
- mounting slots in both short faces
- through holes for mounting in sizes over 1000 mm length on specification
- robust and waterproof
- sealed to IP 65
- suitable for continuous (100%) operation
- for use with control unit type SAV 876.10 (chapter 04)

Auxiliary equipment:

- sidestop rail on short and long face
- connecting cable, 3 m, on the right-hand, short face
- lifting bolts on larger models

Electro Magnetic Chuck

SAV 243.41

With fine longitudinal pole pitch $P = 4 \text{ mm}$

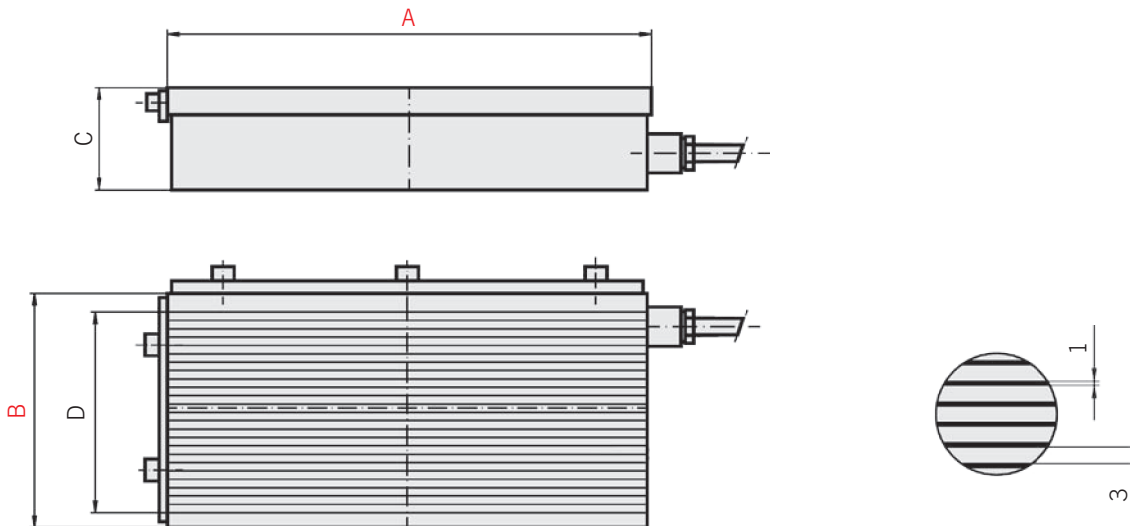

| Dimensions in mm | | | | Power rating in W | Weight in kg |
|------------------|-----|----------------|-----|-------------------|--------------|
| A | B | C ₁ | D | | |
| 200 | 100 | 87 | 53 | 30 | 13.0 |
| 300 | 100 | 87 | 53 | 45 | 20.0 |
| 300 | 150 | 87 | 101 | 65 | 29.0 |
| 400 | 150 | 87 | 101 | 90 | 39.0 |
| 450 | 175 | 87 | 125 | 106 | 51.0 |
| 400 | 200 | 87 | 149 | 118 | 52.0 |
| 500 | 200 | 87 | 149 | 140 | 64.0 |
| 600 | 200 | 87 | 149 | 162 | 77.0 |
| 800 | 200 | 87 | 149 | 206 | 103.0 |
| 500 | 250 | 87 | 197 | 150 | 81.0 |
| 600 | 250 | 87 | 197 | 180 | 97.0 |
| 800 | 250 | 87 | 197 | 233 | 129.0 |
| 500 | 300 | 87 | 253 | 175 | 97.0 |
| 600 | 300 | 87 | 253 | 206 | 116.0 |
| 800 | 300 | 87 | 253 | 268 | 155.0 |
| 1000 | 300 | 87 | 253 | 330 | 193.0 |

| Dimensions in mm | | | | Power rating in W | Weight in kg |
|------------------|-----|----------------|-----|-------------------|--------------|
| A | B | C ₁ | D | | |
| 600 | 350 | 87 | 301 | 235 | 135.0 |
| 800 | 350 | 87 | 301 | 305 | 180.0 |
| 1000 | 350 | 87 | 301 | 375 | 225.0 |
| 600 | 400 | 87 | 349 | 265 | 155.0 |
| 700 | 400 | 87 | 349 | 305 | 180.0 |
| 800 | 400 | 87 | 349 | 345 | 206.0 |
| 1000 | 400 | 87 | 349 | 425 | 258.0 |
| 1200 | 400 | 87 | 349 | 510 | 310.0 |
| 800 | 500 | 87 | 453 | 420 | 257.0 |
| 1000 | 500 | 87 | 453 | 510 | 322.0 |
| 1200 | 500 | 87 | 453 | 612 | 386.0 |

Other sizes and operating voltages available on request. Larger clamping surfaces can be made by flush mounting several units.

Please refer to SAV 876.10 to SAV 876.06, for details regarding suitable control units, based on the power rating

Ordering example: **Electro Magnetic Chuck SAV 243.41 - 300 x 150 - 110 V**
 Ordering key: Name SAV - No. - A x B - Operating voltage