

## Precision Sine Table

SAV 245.09

Swivel on longitudinal axis, with electro or electro-permanent chuck

### Design:

Swivel on the longitudinal axis.

The base plate of the sine table is made of hardened steel (HRC 60), black-finished and precision ground. Magnetic chuck housing stress-free annealed. High accuracy due to extreme flat construction.

4-point support for optimal security. The delivery includes a lifting support and setting table degrees / minutes in mm.

Fluting stones for fixing on the machine table on bottom side of base plate.

Side stops on back and side face sides.

This sine table is executed either with electro-magnetic with integrated water cooling (EM) or electro-permanent chuck (EP).

Angle precision:  $\pm 5$  sec.

Planar parallelism:  $\pm 0.005 / 100$  mm

Shimming measure at 0°: 3 mm

Angle range: 0° to 45°

Nominal holding force: 100 N/cm<sup>2</sup>

Pole pitch:

4 mm for Electro Permanent Chuck

SAV 243.73

13 mm for Electro Magnetic Chuck

SAV 243.42

### Application:

The angle is set according the sine principle, using an end-gauge.

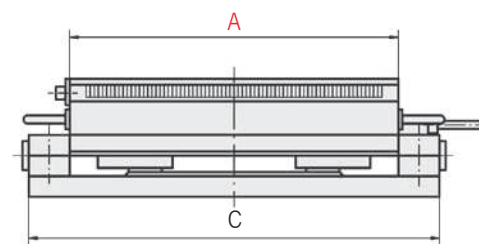
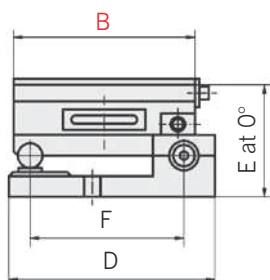

Dimensions in mm						Weight in kg
A	B	C	D	E <sub>0</sub>	F	
450	175	448	203	125.5	175	55.0
500	175	498	203	125.5	175	61.0
500	200	498	228	125.5	200	70.0

Suitable control unit SAV 876.10 (chapter 4)

Other dimensions on request.

Ordering example: Precision Sine Table SAV 245.09 - 500 x 200 - EP

Ordering key: Name SAV No. - A x B - Execution