

SAV 434.87**PRECISION CYLINDRICAL GRINDING UNIT**

With side drive

**APPLICATION**

For surface grinding machines in individual and small-batch production in toolmaking, die making and mould making. Special device for profile, cylindrical and plunge grinding. Suitable for continuous operation.

DESIGN

With Deckel spindle taper 355 E. Axial angular ball bearing unit pre-tensioned without play. Maintenance-free, robust DC motor. Protection rating IP 65, splash water protected. Control unit **SAV 875.41** included in the delivery. Manufactured from hardened, precision-ground steel. 20 mm free spindle sleeve clearance thanks to side drive. Planetary gears with gear ration 1 : 3. Clockwise/counter-clockwise rotation continuously adjustable from 70 to 430 rpm. Wooden box **SAV 539.23**, available subject to a surcharge.

**ACCESSORIES**

- Three-jaw chuck:
D = 80 mm. SAV 439.62 - 80 - D
- Four-jaw chuck:
D = 80 mm. SAV 439.63 - 80 - D
- Permanent magnetic circular chuck:
D = 100 mm. SAV 244.03 - 100 - D
- Flat disc:
D = 90 mm. SAV 439.64 - 90 - D
- Sine disc with clamping device.
SAV 439.72 - T 100 - S
- Collet chuck Deckel no. 355 E:
D = 1.0 to 18.0 mm
or complete set from D = 3.0 to 18.0 mm
(set) SAV 439.66 - 355 E - 4.0



Workpiece samples

Precision cylindrical grinding unit:

| | | |
|--------------------------|-------|----------|
| Length | in mm | 130 |
| Width | in mm | 180 |
| Height | in mm | 112 |
| Total length incl. motor | in mm | 350 |
| Spindle height | in mm | 67 |
| Spindle concentricity | in mm | 0.002 |
| Speed | rpm | 70 - 430 |
| Weight | in kg | 8.9 |

Control:

| | | |
|--------|-------|-----|
| Width | in mm | 230 |
| Height | in mm | 70 |
| Depth | in mm | 112 |
| Weight | in kg | 2.2 |

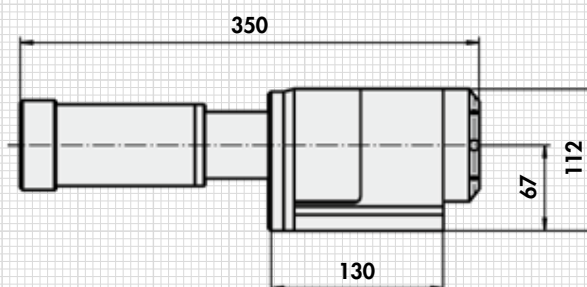
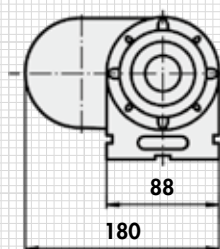
**ORDERING EXAMPLE**

| Designation | SAV no. |
|-------------------------------------|------------|
| Precision cylindrical grinding unit | SAV 434.87 |