

SAV 240.36

HOLDING MAGNETS

High-energy magnets, stud with internal thread (flat pot magnet)

DESIGN

Shielded system, galvanised surface.
Max. service temperature: 80 °C.

FASTENING OPTION

Screwing in

MAGNET MATERIAL

NdFeB

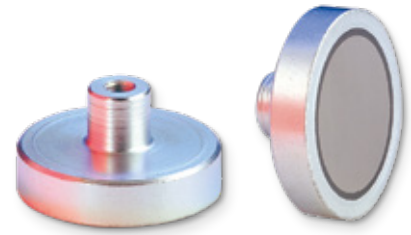

Type	mm						Rated holding force N	Weight kg
	A ±0.2	B ±0.2	C	D	E	F		
MH 36 - 06	6	4.5	M 3	6	11.5	7	5	0.002
MH 36 - 08	8	4.5	M 3	6	11.5	7	13	0.003
MH 36 - 10	10	4.5	M 3	6	11.5	7	25	0.004
MH 36 - 13	13	4.5	M 3	6	11.5	7	60	0.005
MH 36 - 16	16	4.5	M 4	6	11.5	7	95	0.007
MH 36 - 20	20	6	M 4	8	13	7	140	0.016
MH 36 - 25	25	7	M 4	8	14	7	200	0.027
MH 36 - 32	32	7	M 5	10	15.5	8.5	350	0.045

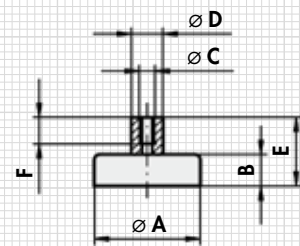

ORDERING EXAMPLE

Designation SAV no. - type
Holding magnet SAV 240.36 - MH 36 - 32