

SAV 243.79

ELECTRO PERMANENT MAGNETIC CHUCKS

Universally suitable system with hexagonal pole pitch



Milling magnet for flexible use with high holding force.

DESIGN

- Optimised high-energy magnet system
- Low height
- Electro permanent magnetic system for absolute safety in case of power failure.
- Tapped hole grid M8 for optional pole shoes
- Protection rating IP 65
- 8 mm wear layer of the pole plate

RATED HOLDING FORCE

- On workpiece: 150 N/cm²
- Per pole pair: 900 daN

RATED VOLTAGE

360 V IMP

APPLICATION

For milling, especially for universal machining with high level of material removal

- HSC milling
- Also suitable for larger air gaps
- Min. thickness of the workpiece: 12 mm
- Min. workpiece size: 100 x 100 mm

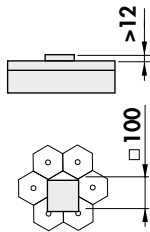

The magnetic chucking and the free side access allow 5-sided machining with pole shoes SAV 248.70.

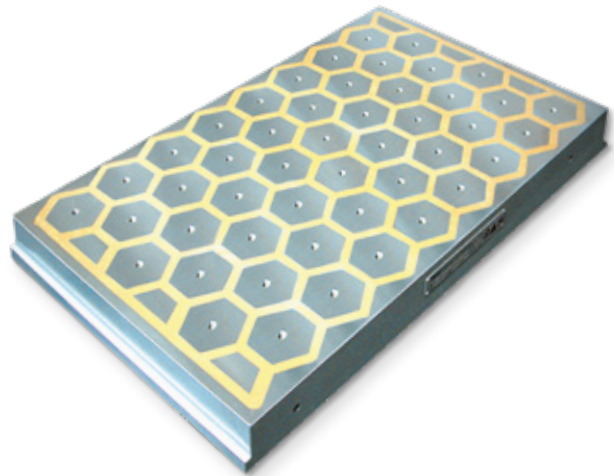

SCOPE OF DELIVERY

- Up to 400 mm width with 2 clamps, with 4 clamps for larger widths
- 5 m connecting cable, protective hose optionally possible
- Includes lifting plates
- Control and control unit not included (see SAV 876.17)
- Clamps

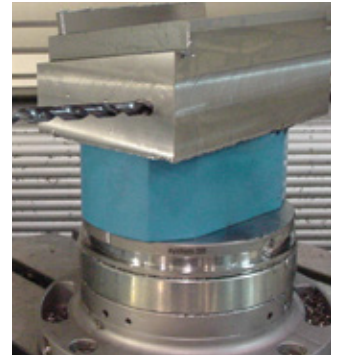

Special version for pallets on 5-axis machine

mm			Qty.	kg	A
A	B	C ₀	No. of poles	Weight	Control max. pul. Current
360	250	74	12	49.0	30
360	350	74	20	68.0	30
500	350	74	30	96.0	30
630	450	74	48	155.0	60
770	500	80	56	211.0	60x2
920	500	80	84	252.0	60x2

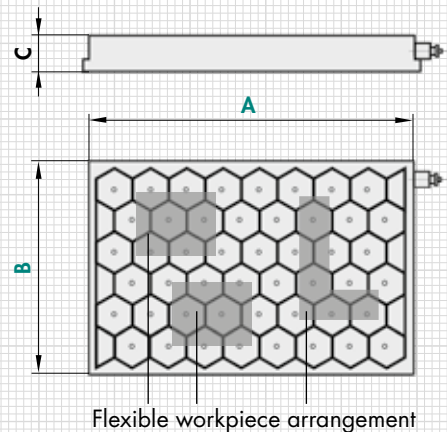

HEAVY-DUTY POWER CONNECTOR WITH QUICK-RELEASE

Optional (surcharge applies)
Easy handling of the plug-in connection

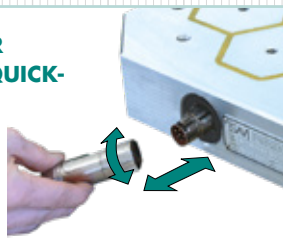

ORDERING EXAMPLE

Designation SAV no. - A x B - number of poles - rated voltage
Electro permanent magnetic chuck SAV 243.79 - 770 x 500 - 56 - 360 V