

SAV 434.01

PRECISION RADIUS DRESSER

For profiling grinding wheels



APPLICATION

The radius dressing unit can be used to profile dressing wheels up to 400 mm diameter with concave or convex radii.

DESIGN

The lapped, robust spindle runs in a honed hole and is sealed against dust. With degree scale. The radius movement is limited by adjustable stops. The arm with the dressing diamond is height-adjustable using threads.

A fine-adjustment screw on the arm can be used to move the diamond into the correct position.

The precision radius dresser is delivered with 3 exchangeable dressing inserts and dressing arm 2 as a standard. 2 additional arms with a larger range for the dressing radius are available.

Arm 3 with a 100 mm raising foot for dressing larger radii.

ACCESSORIES

Dressing diamond SAV 401.01 - K 10, type D

Arm 1 - SAV 434.01 - 1

Arm 3 - SAV 434.01 - 3 - includes support block LxWxH 128x128x100

All subject to a surcharge.



Arm	mm		
	1	2*	3
Concave dressing radius	19-112	0-22/108-155	151-199
Convex dressing radius	-	0-25	21-68
Arm length A	143	143	158

* included in the delivery

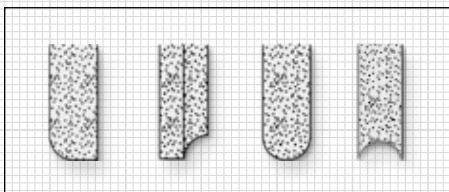

Examples for profiled grinding wheels

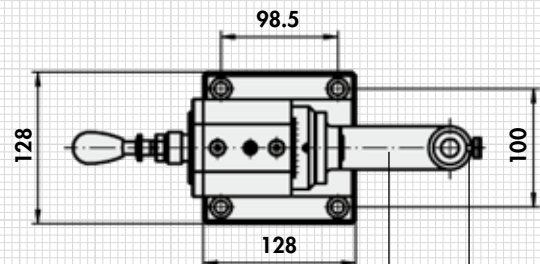
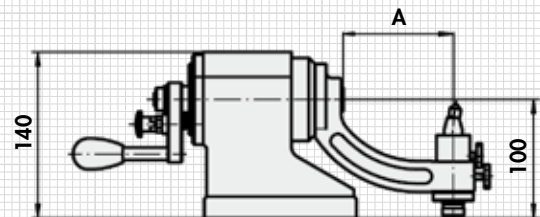

Dressing arm 1, 2 or 3

Dressing insert (set of 3)
Included in the delivery

ORDERING EXAMPLE

Designation SAV no. - arm

Precision radius dresser SAV 434.01 - 3

Benennung

Präzisions-Radien-Abrichtgerät

SAV Nr. - Arm

SAV 434.01 - 3