

**SAV 240.35**

**HOLDING MAGNETS**

Stud with internal thread (flat pot magnet), extremely high rated holding force

**DESIGN**

Shielded system, galvanised surface.  
Max. service temperature: 200 °C.

**FASTENING OPTION**

Screws

**MAGNET MATERIAL**

SmCo<sub>5</sub>

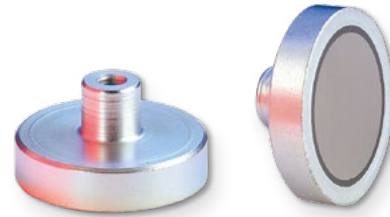

Type	mm						Rated holding force N	Weight kg
	A ±0.2	B ±0.2	C	D	E	F		
MH 35 - 06	6	4.5	M 3	6	11.5	7	5	0.002
MH 35 - 08	8	4.5	M 3	6	11.5	7	11	0.002
MH 35 - 10	10	4.5	M 3	6	11.5	7	20	0.003
MH 35 - 13	13	4.5	M 3	6	11.5	7	40	0.005
MH 35 - 16	16	4.5	M 4	8	11.5	7	60	0.008
MH 35 - 20	20	6	M 4	8	13	7	90	0.016
MH 35 - 25	25	7	M 4	8	14	7	150	0.022
MH 35 - 32	32	7	M 5	10	15.5	8.5	220	0.040

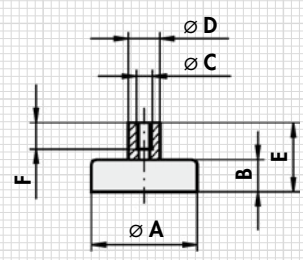

**ORDERING EXAMPLE**

Designation SAV no. - type  
Holding magnet SAV 240.35 - MH 35 - 20

**SAV 240.04**

**HOLDING MAGNETS**

With internal thread (bar magnet)

**DESIGN**

Bar magnet, smooth without fitting tolerance.  
Shielded system.  
Max. service temperature: 450 °C.

**FASTENING OPTION**

Screws

**NOTE**

Amplified version, see SAV 240.14 NdFeB.  
For use in injection moulds with high injection pressure please contact us.

**MAGNET MATERIAL**

AlNiCo 500



Type	mm				Rated holding force N	Weight kg
	A ±0.2	B ±0.2	C	D		
MH 11 - 06	6	20	M 3	5	1.7	0.003
MH 11 - 08	8	20	M 3	5	4	0.006
MH 11 - 10	10	20	M 4	7	8.5	0.010
MH 11 - 13	13	20	M 4	7	12	0.016
MH 11 - 16	16	20	M 4	5	20	0.025
MH 11 - 20	20	25	M 6	7	45	0.055
MH 11 - 25	25	35	M 6	9	100	0.135
MH 11 - 32	32	40	M 8	9	190	0.230

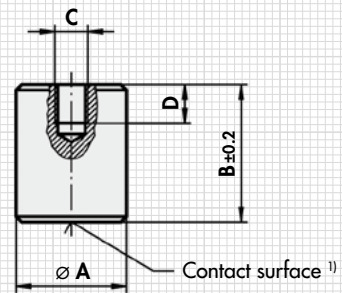

**NOTE**

<sup>1)</sup> In case of changes to the contact surface, no more than 2 mm may be removed, as otherwise the holding force decreases greatly.