

SAV 241.06

BAR MAGNETS

Pairs, rectangular and round cross-section

DESIGN

Surface with wrinkle paint finish, red, unshielded.

Max. service temperature:

- 100 °C for paint
- 400 °C for magnet material

MAGNET MATERIAL

AlNiCo 500

FASTENING OPTION

Pressing, glueing.

NOTE

Supplied in pairs. Machining: grinding only.



Rectangular bar magnets:

Type	mm			kg
	A	B	C	
MH 630	20	10	5	0.005
MH 631	60	15	5	0.055
MH 632	50	15	10	0.063
MH 633	75	15	10	0.118
MH 634	101	15	10	0.174
MH 635	40	12.5	5	0.030
MH 636	60	12.5	5	0.036

Round bar magnets:

Type	mm		kg
	A	B	
MH 620	10	4	0.001
MH 621	10	5	0.001
MH 622	10	6	0.001
MH 623	20	5	0.002
MH 624	20	6	0.003
MH 625	24	8	0.007
MH 626	30	10	0.018

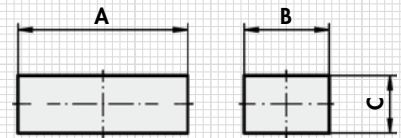

Type MH 630 to type MH 636

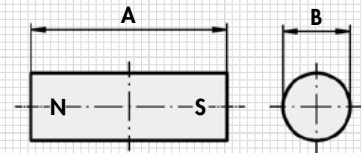

Type MH 620 to type MH 626

ORDERING EXAMPLE

Designation SAV no. - type

Bar magnet SAV 241.06 - MH 635

SAV 241.14

STRONG MAGNETS

U-shaped with fastening holes

DESIGN

U-shaped magnet with high rated holding force, through hole for fastening from type MH 14-17. Contact surfaces polished.

To prevent demagnetising, an iron plate must be provided across both poles. Surface with wrinkle paint finish, red.

Max. service temperature:

- 100 °C for paint
- 400 °C for magnet material

MAGNET MATERIAL

AlNiCo, cast

FASTENING OPTION

Screws, glueing

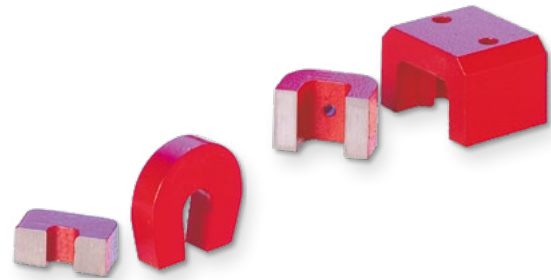

Type	mm							N	kg
	A	B	C	D	E	F	G		
MH 14 - 05	21.4	11.3	8	-	7.8	6.5	3.3	20	0.012
MH 14 - 10	28.5	25.3	7.4	-	8	7	15	35	0.026
MH 14 - 17	22	22	25	7	7	8	9	45	0.010
MH 14 - 20	30.4	20.3	20.3	5	8	15	11	40	0.063
MH 14 - 25	38.1	25.4	25.4	5	9.5	19.1	14.5	90	0.133
MH 14 - 29	44.4	29.5	28.6	5.8	11.1	22.2	17	120	0.197
MH 14 - 35	58	35	44	8	11	28	23	230	0.500
MH 14 - 39	60	39.2	61.5	7	14	32	26	250	0.830
MH 14 - 41	70	41	57	8	15	40	26	320	1.000
MH 14 - 54	78	54	82	10.5	15	48	36	470	2.200

ORDERING EXAMPLE

Designation SAV no. - type

Strong magnet SAV 241.14 - MH 14 - 29

