



Electromagnet systems with very narrow pole pitch. Especially suitable for thin parts. Main workpiece axis at right angle to the magnet length.



### DESIGN

- Pole plate with particularly narrow, continuous longitudinal pole pitch, 3 mm steel and 1 mm brass
- Pole divisions bonded and additionally bolted together solidly with tie rods
- Pole plates bolted in a narrow grid
- 8 mm wear layer on the pole plate
- Low magnetic field height of 4 mm
- Chucking slots on both face sides
- Length over 1000 mm with through holes for fastening upon agreement
- Robust and water-tight
- Protection rating IP 65
- 100 % duty cycle
- Suitable for connecting to the SAV 876.10 control unit

### RATED HOLDING FORCE

100 N/cm<sup>2</sup>, controllable with control unit using holding force coding switch

### RATED VOLTAGE, RECOMMENDED

24 V DC up to and including 106 W

110 V DC for all other sizes

### APPLICATION

For chucking thin, plate-shape workpieces with shape and position tolerances of 0.01 to 0.02 mm.

- For main workpiece axis perpendicular to the pole pitch

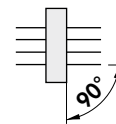

- For thin workpieces up to:  
min. thickness = 2 mm



- For flat workpieces:  
min. width = 40 mm

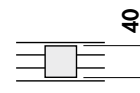

### SCOPE OF DELIVERY

- Stop bar on one short and one long side
- 3 m connecting cable on right short side, rear
- Larger magnetic chucks are provided with lifting lugs for transport
- Control and hand remote unit not in the scope of delivery
- Clamps

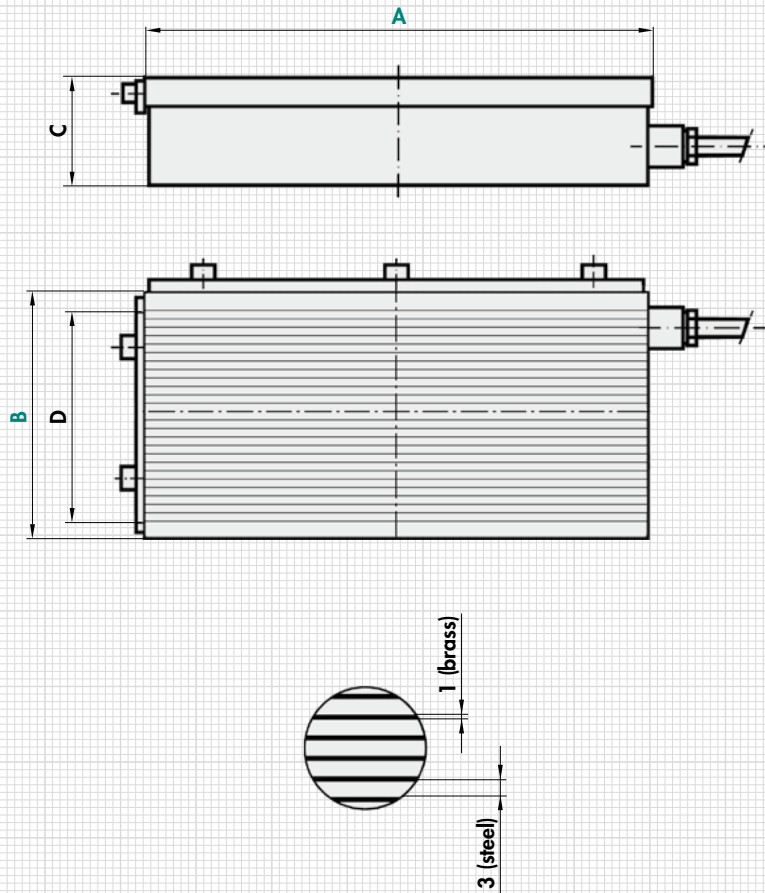

mm				W	kg	Type
A	B	C <sub>0.1</sub>	D	Power	Weight	Control
200	100	87	61	30	13.0	E 1
300	100	87	61	45	20.0	E 1
300	150	87	101	65	29.0	E 1
400	150	87	101	90	39.0	E 1
450	175	87	125	106	51.0	E 1
400	200	87	149	118	52.0	E 4
500	200	87	149	140	64.0	E 4
600	200	87	149	162	77.0	E 4
800	200	87	149	206	103.0	E 4
500	250	87	197	150	81.0	E 4
600	250	87	197	180	97.0	E 4
800	250	87	197	233	129.0	E 4
500	300	87	257	175	97.0	E 4
600	300	87	257	206	116.0	E 4
800	300	87	257	268	155.0	E 4
1000	300	87	257	330	193.0	E 4

Other sizes and rated voltages on request. Larger chucking areas can be implemented by joining several blocks without gaps.

mm				W	kg	Type
A	B	C <sub>0.1</sub>	D	Power	Weight	Control
600	350	87	301	235	135.0	E 4
800	350	87	301	305	180.0	E 4
1000	350	87	301	375	225.0	E 4
600	400	87	345	265	155.0	E 4
700	400	87	345	305	180.0	E 4
800	400	87	345	345	206.0	E 4
1000	400	87	345	425	258.0	E 4
1200	400	87	345	510	310.0	E 4
800	500	87	453	420	257.0	E 4
1000	500	87	453	510	322.0	E 4
1200	500	87	453	612	386.0	E 4

### RECOMMENDED CONTROL AND CONTROL UNIT

Type	Control	Hand remote unit
E 1	SAV 876.10-S-T-24/7/230	SAV 876.02-SE3
E 4	SAV 876.10-S-O-110/6/230	SAV 876.02-SE3

Installation control units or for combinations as per page 74.

### ORDERING EXAMPLE

Designation SAV no. - A x B - rated voltage  
 Electro magnetic chuck SAV 243.41 - 1200 x 500 - 110 V