

**SAV 434.01**

**PRECISION RADIUS DRESSER**

For profiling grinding wheels



**APPLICATION**

The radius dressing unit can be used to profile dressing wheels up to 400 mm diameter with concave or convex radii.

**DESIGN**

The lapped, robust spindle runs in a honed hole and is sealed against dust. With degree scale. The radius movement is limited by adjustable stops. The arm with the dressing diamond is height-adjustable using threads.

A fine-adjustment screw on the arm can be used to move the diamond into the correct position.

The precision radius dresser is delivered with 3 exchangeable dressing inserts and dressing arm 2 as a standard. 2 additional arms with a larger range for the dressing radius are available.

Arm 3 with a 100 mm raising foot for dressing larger radii.

**ACCESSORIES**

Dressing diamond SAV 401.01 - K 10, type D

Arm 1 - SAV 434.01 - 1

Arm 3 - SAV 434.01 - 3 - includes support block LxWxH 128x128x100

All subject to a surcharge.



Arm	mm		
	1	2*	3
Concave dressing radius	19-112	0-22/108-155	151-199
Convex dressing radius	-	0-25	21-68
Arm length A	143	143	158

\* included in the delivery

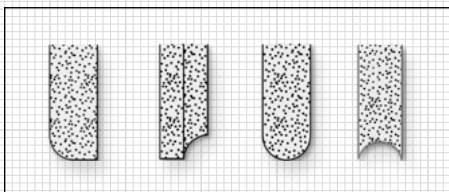

Examples for profiled grinding wheels

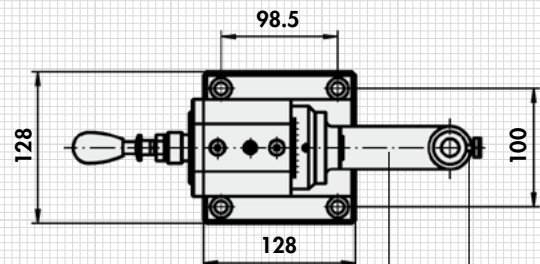
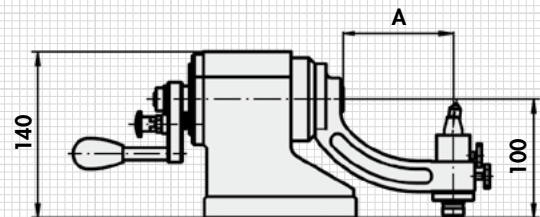

Dressing arm 1, 2 or 3  
Dressing insert (set of 3)  
Included in the delivery

**ORDERING EXAMPLE**

Designation SAV no. - arm  
Precision radius dresser SAV 434.01 - 3

Benennung SAV Nr. - Arm  
Präzisions-Radien-Abrichtgerät SAV 434.01 - 3